

02 Centrifugal Pumps

STAINLESS STEEL PUMPS



CYCLONE™ STAINLESS STEEL CENTRIFUGAL PUMP



FOR INTERNATIONAL & US MARKETS

The combination of reliability, performance, and silent operation is what makes the Cyclone™ range the class leader and why these robust pumps are supported by many major customers and OEMs worldwide. The Hybrid Cyclone™ model was developed in response to industry application requirements and our customers needs to increase the pump's versatility and performance criteria.



FEATURES

- Heavy duty robust design
- Stainless steel construction
- Long life DC motor
- Silent running
- Anti-clog impeller design
- Long life mechanical seal
- Single tool servicing
- 6.56 feet (2 meters) suction lift when wet

PERFORMANCE

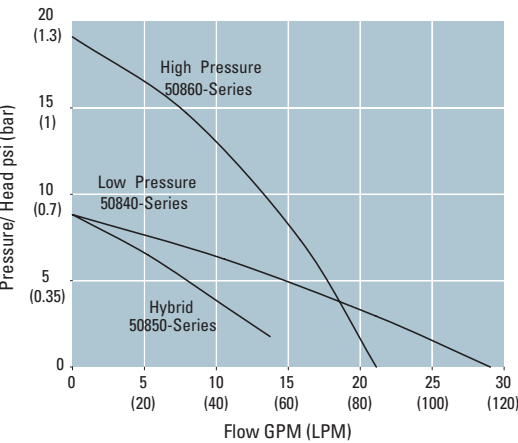

GAS WARNING

No pump manufactured by Xylem should be used for gasoline or any fluid with a flash point below 100° F (38° C)

SPECIFICATION

MODEL #S	CERTIFICATION	DESCRIPTION	VOLTAGE	FUSE SIZE	PORT FITTING	OPEN FLOW	RECOMMENDED DUTY	MOTOR LIFE
50840-0012	CE	CYCLONE LOW PRESSURE	12V	10	¾" (19mm) NPT	31GPM/120LPM	Continuously rated	3500 HOURS
50840-0024	CE	CYCLONE LOW PRESSURE	24V	5	¾" (19mm) NPT	31GPM/120LPM	Continuously rated	3500 HOURS
50840-2012	CE	CYCLONE LOW PRESSURE	12V	10	¾" (19mm) BSP	31GPM/120LPM	Continuously rated	3500 HOURS
50840-2024	CE	CYCLONE LOW PRESSURE	24V	5	¾" (19mm) BSP	31GPM/120LPM	Continuously rated	3500 HOURS
50850-0012	CE	CYCLONE HYBRID	12V	7	¾" (19mm) NPT	13GPM/50LPM	Continuously rated	3500 HOURS
50850-2012	CE	CYCLONE HYBRID	12V	7	¾" (19mm) BSP	13GPM/50LPM	Continuously rated	3500 HOURS
50850-2124	CE	CYCLONE HIGH PRESSURE	24V	5	¾" (19mm) BSP	13GPM/50LPM	Continuously rated	3500 HOURS
50860-0012	CE	CYCLONE HIGH PRESSURE	12V	25	¾" (19mm) NPT	21GPM/80LPM	30 MINUTES ON, 30 minutes off	2500 HOURS
50860-0024	CE	CYCLONE HIGH PRESSURE	24V	15	¾" (19mm) NPT	21GPM/80LPM	30 MINUTES ON, 30 minutes off	2500 HOURS
50860-2012	CE	CYCLONE HIGH PRESSURE	12V	25	¾" (19mm) BSP	21GPM/80LPM	30 MINUTES ON, 30 minutes off	2500 HOURS
50860-2024	CE	CYCLONE HIGH PRESSURE	24V	15	¾" (19mm) BSP	21GPM/80LPM	30 MINUTES ON, 30 minutes off	2500 HOURS

50840 SERIES
DIMENSIONAL DRAWINGS

Unless otherwise stated dimensions in [] are in mm.

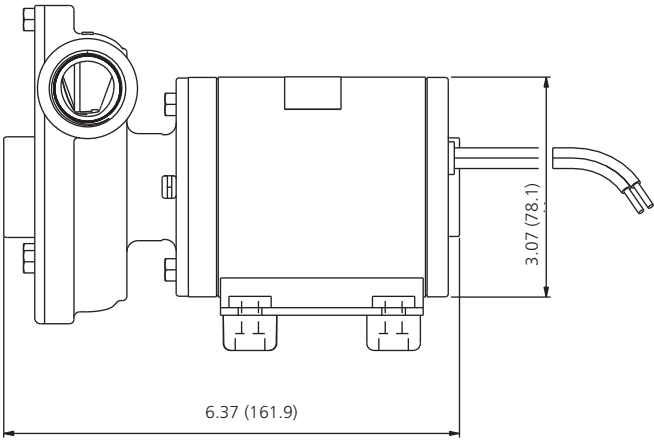
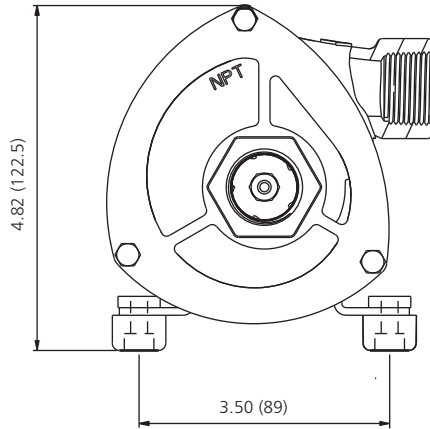

50850 SERIES
DIMENSIONAL DRAWINGS

Unless otherwise stated dimensions in [] are in mm.

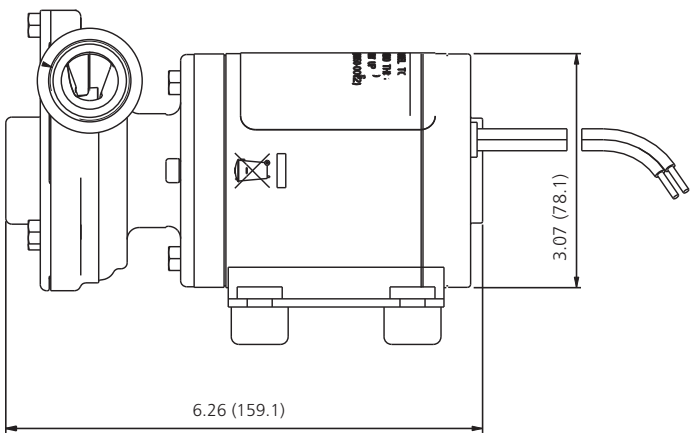
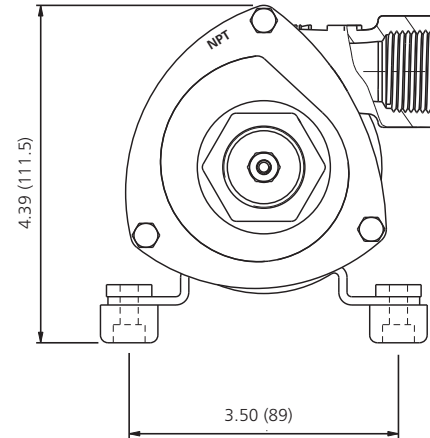

50860 SERIES
DIMENSIONAL DRAWINGS

Unless otherwise stated dimensions in [] are in mm.

