



## Shell-and-tube Dry Expansion Evaporator - DH model

High efficiency evaporator optimized for R407F/C and R410A applications



### Application

The new DH evaporator has been developed for commercial and industrial refrigeration cooling applications with positive temperatures as air conditioning or industrial process cooling. These applications are typically demanding an evaporation temperatures in a range of 0/+10°C depending on the system efficiency.

The DH models will replace the current Dryplus-3 ones.

### Technology

- A unique patented refrigerant distribution system which has been optimized for R407F/C and R410A. It can also work with R134a as well as other HFC/HFO refrigerants.
- Innovative plastic baffles to improve the shell side heat transfer performances.
- DH offers the same capacity of current Dryplus-3 model with a reduced length up to -30%

### Benefits

- Easy to replace Dryplus-3.
- Easy to buy from Alfa Laval e-business portal " Anytime ".
- Easy to receive a prompt support from our qualified product experts.
- Easy to handle and stock thanks to the compact design.
- Easy to reduce the environmental impact with an equivalent CO2 emission -25% vs Dryplus-3.

### Guidelines for quotation

- Thermal sizing: Smart Tube calculation software
- Pricing: RCPL (Recommended Customer Price List)
- Product information: available on demand, contact your local Alfa Laval sales organization

**Basic features**

- Brine connection top, right or left side orientations available
- From 1 to 4 refrigerant circuits
- 5 shell diameters from 140 to 508 mm (5 to 24 inch)
- Total length L from 1500 to 2850 mm ( 5 to 9.4 foot)

**Standard component material**

- Shell, tube-sheets: Carbon steel
- Headers: Carbon steel
- Tubes: Copper
- Baffles: Plastic polymer

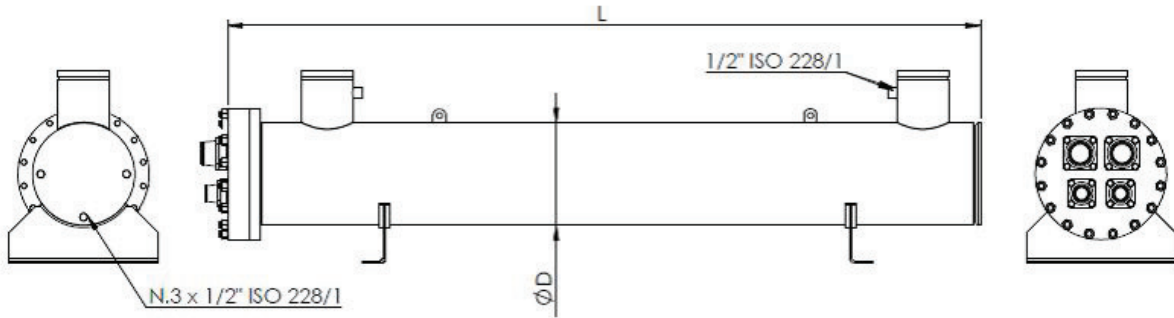

**Working principle- evaporator mode**

- The refrigerant is running inside the tubes in a two pass configuration.
- The brine is flowing in the shell side outside the tubes in a counter cross flow.

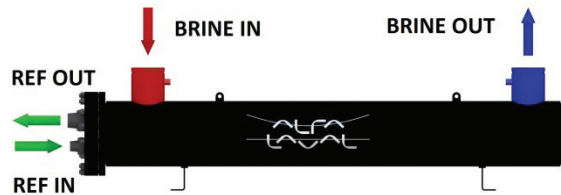

**PED (CE) approval**

Version	Tube side				Shell side			
	PS (bar)	TS(°C)	T <sub>min</sub> (°C)	PT (bar)	PS (bar)	TS (°C)	T <sub>min</sub> (°C)	PT (bar)
MP	30	90	-10	42.9	10	60	-10	14.3
HP	45	90	-10	64.4	10	60	-10	14.3

- PS = Pressure Service
- TS = Temperature Service
- T<sub>min</sub> = Temperature minimum
- PT = Pressure Test

- ASME / SELO approval available on request
- GL / DNV / ABS approval available on request

**Available on request**

- Supporting feet
- Flanges and victaulic flanges
- Removable tube bundle
- Insulation 9 mm – 19 mm (¾")
- Tubes in CuNi 90/10, AISI 316L and Carbon steel
- Shell in AISI 316L

**How to contact Alfa Laval**

Up-to-date AlfaLaval contact details for all countries are always available on our website on [www.alfalaval.com](http://www.alfalaval.com)